

TYPES OF FLANGES EN 1092-1

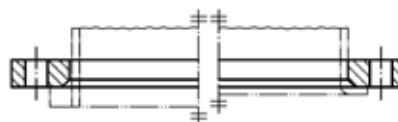

Type 01
Plate flange for welding



Type 02
Loose plate flange with weld-on collar (see type 32) or lapped pipe end (see type 33)

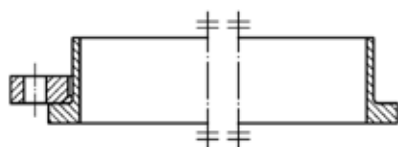

Type 02
Loose plate flange with weld ring neck (see type 35)

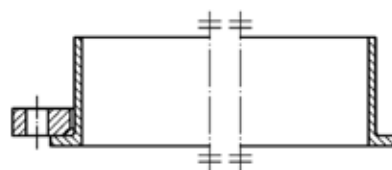

Type 02
Loose plate flange with pressed collar with long neck (see type 36)

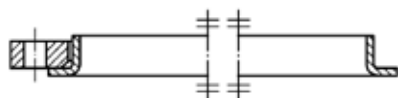

Type 02
Loose plate flange with pressed collar (see type 37)



Type 04
Loose plate flange with weld-neck collar (see type 34)

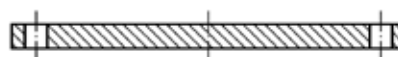

Type 05
Blind flange



Type 11
Weld-neck flange

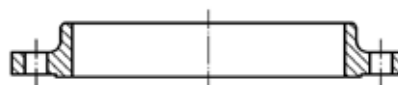

Type 12
Hubbed slip-on flange for welding



Type 13
Hubbed threaded flange

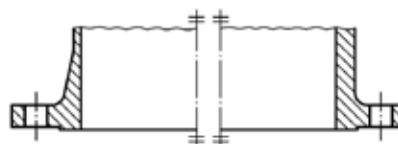

Type 21
Integral flange

TYPES OF COLLARS EN 1092-1

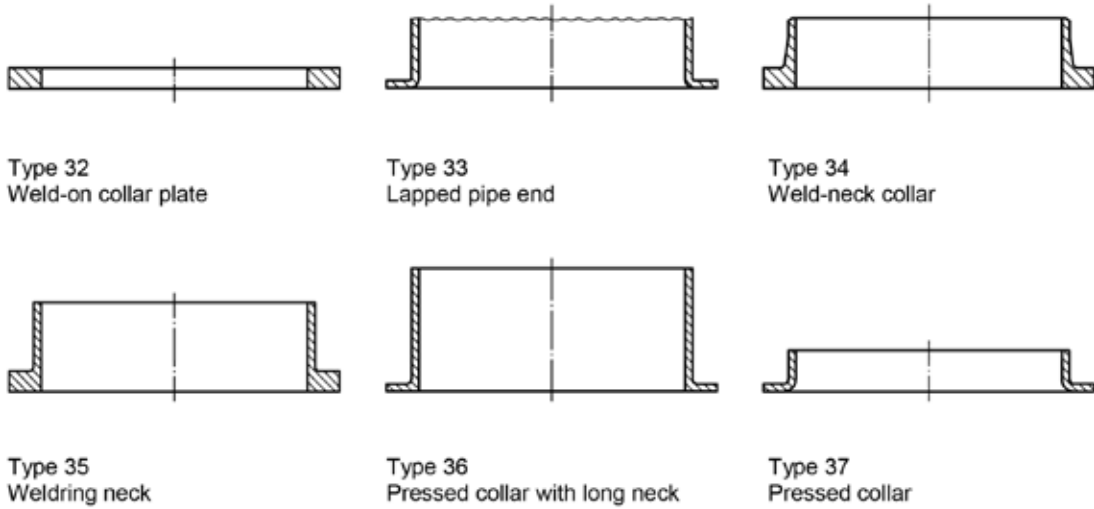

FACE TYPES OF FLANGES EN 1092-1

